

FaceStation F2

Fusion Multimodal Terminal



Unrivaled
Face Recognition
Performance



Best-in-class
Multimodal Device



Contactless Solution
for the New Normal



Robust Device Security and
Data Encryption

suprema
SECURITY & BIOMETRICS



Unrivaled face recognition performance by Fusion Matching

FaceStation F2 boasts exceptional authentication accuracy achieved by the fusion matching of visual and infrared(IR) face recognition.

*False Acceptance Rate(FAR) of 1 in 10 billion.



- Suprema's unique algorithm optimizes IR and visual face recognition to produce the industry's best face recognition and anti-spoofing performance
- Proven track record of authentication performance regardless of user ethnicity and face changes powered by deep learning algorithm

Best-in-class multimodal with various credentials

FaceStation F2 offers a wide range of authentication options including face, mobile access, fingerprint and cards.



Face



Fingerprint



Mobile Access



Card

- Register up to 100,000 users for fingerprints authentication and 50,000 users for face authentication
- Supports dual frequency access cards, NFC and BLE-based Mobile Access Cards
- Template-on-Card allows authentication via biometric data stored in cards

AI Deep learning-based AI algorithm applied for live face/fingerprint detection

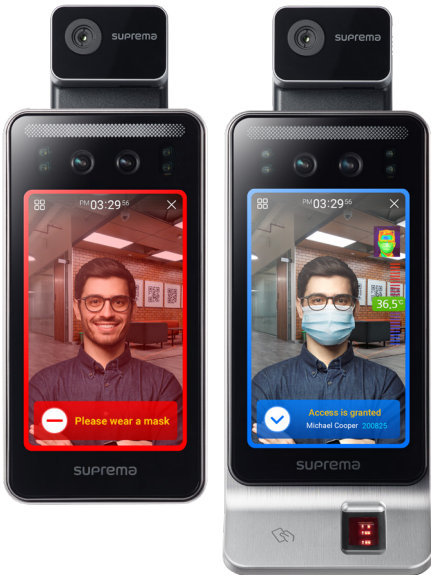

Contactless solution for new standards of safety and hygiene

FaceStation F2 meets the needs of the post-pandemic world with remote and contactless solution.

- Detects and limits access of users not wearing masks
- Face recognition of users wearing masks
- Remote user enrollment through profile photo uploads
- Combines with Suprema Thermal Camera to identify users with elevated skin temperature

Robust device security and data encryption

FaceStation F2 is equipped with security measures to protect user data.

- Highest level of device security including secure booting process
- Encrypts all biometric credentials and personal information



System Configurations

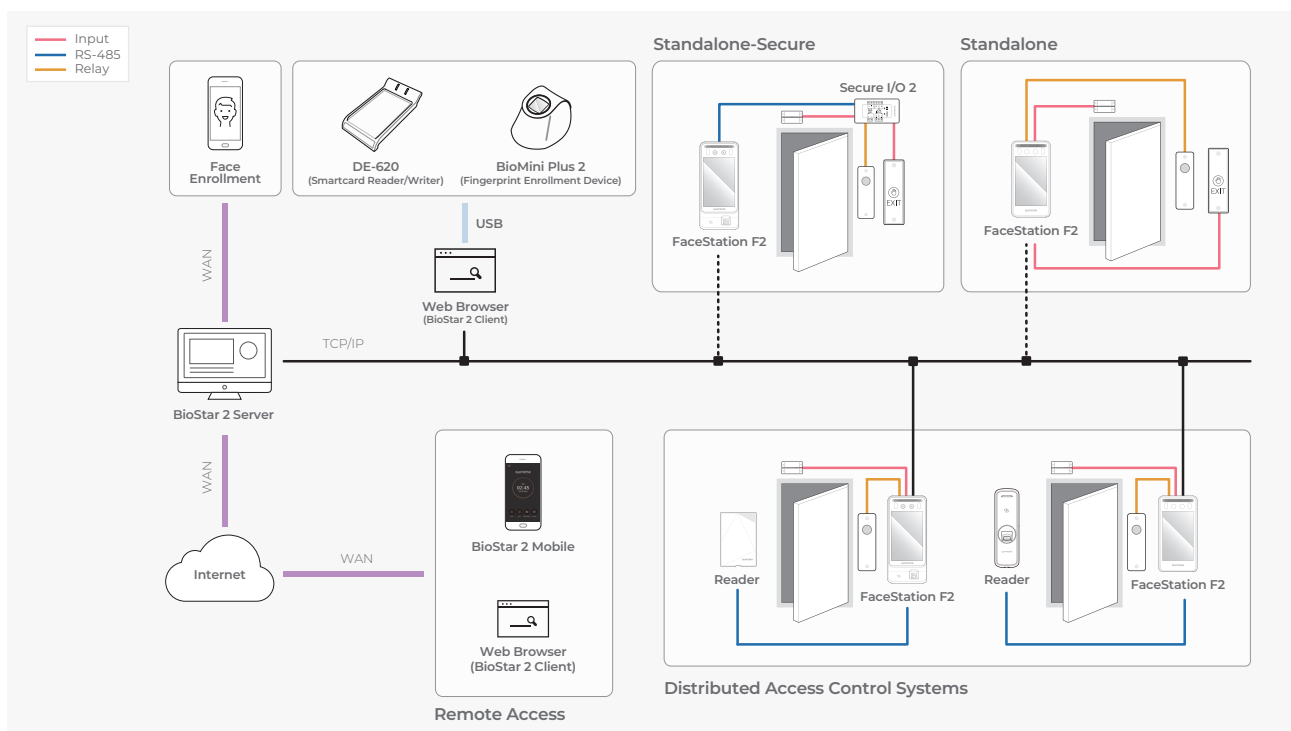

Product Specification



| Category | Feature | FSF2-DB | FSF2-AB | FSF2-ODB | |
|--------------|---|---|--|---|------|
| Credential | Biometric | Face | | Face, Fingerprint | |
| | RF Option | 125kHz EM & 13.56MHz MIFARE, MIFARE Plus, DESFire EV1/EV2 ⁽¹⁾ , FeliCa | 125kHz EM, HID Prox & 13.56MHz MIFARE, MIFARE Plus, DESFire EV1/EV2 ⁽¹⁾ , FeliCa, iCLASS SE/SR/Seos | 125kHz EM & 13.56MHz MIFARE, MIFARE Plus, DESFire EV1/EV2 ⁽¹⁾ , FeliCa | |
| | RF Read Range ⁽²⁾ | EM/MIFARE/DESFire : 50 mm (2"), FeliCa: 30 mm (1.2") | | | |
| General | Mobile | NFC, BLE | | | |
| | CPU | 1.8 GHz Dual Core + 1.4 GHz Quad Core | | | |
| | Memory | 16GB Flash + 2GB RAM | | | |
| | LCD Type | 7" IPS color LCD | | | |
| | LCD Resolution | 800 x 1280 pixels | | | |
| | Sound | 16bit | | | |
| | Operating Temperature | -20°C ~ 50°C (-68°F ~ 122°F) | | | |
| | Operating Humidity | 0% ~ 80%, non-condensing | | | |
| | Dimension (W x H x D) | 119.8mm x 223mm x 23.5mm (4.7" x 8.8" x 0.9") | | 119.8mm x 268.4mm x 49.7mm (4.7" x 10.6" x 1.9") | |
| | Weight | Device | 585g | | 670g |
| | | Bracket (Including washer and bolt) | 181g | | 205g |
| IP Rating | IP65 | | | | |
| Certificates | CE, FCC, KC, RoHS, REACH, WEEE | | | | |
| Face | Recognition Distance | 0.5m ~ 1.3m (19.7" ~ 51.2") | | | |
| | Recognition Height | 140cm ~ 190cm (55.1" ~ 74.8") | | | |
| | Matching Speed | Less than 0.5 sec | | | |
| | Live Face Detection (Anti-Spoofing) | Supported | | | |
| Fingerprint | Image Dimension | | | 300 x 400 pixels | |
| | Resolution | | | 500 dpi | |
| | Template | | | SUPREMA / ISO19794-2, ANSI-378 | |
| | Extractor / Matcher | N/A | | MINEX certified and compliant | |
| | Sensor Certificates | | | FBI PIV and FBI Mobile ID FAP20 | |
| | Live Fingerprint Detection | | | Supported (Deep learning-based) | |
| Capacity | Max. User (1:1) * Based on one face/fingerprint enrollment per user | 100,000 | | | |
| | Max. User (1:N) * Based on one face/fingerprint enrollment per user | Face: 50,000 | | Face: 50,000 Fingerprint: 100,000 | |
| | Max. Text Log | 5,000,000 | | | |
| | Max. Image Log | 50,000 | | | |
| Interface | Ethernet | 10/100 Mbps, auto MDI/MDIX | | | |
| | RS-485 | 1ch Host or Slave (Selectable) | | | |
| | Wiegand | 1ch Input or Output (Selectable) | | | |
| | TTL Input | 2ch Inputs | | | |
| | Relay | 1 Relay | | | |
| | USB | USB 2.0 (Host) | | | |
| | Tamper | Supported | | | |
| Power | Voltage: DC 12V ~ DC 24V Current: Max. 2.5 A * Use a 24V/2.5A adapter. Must follow the product manual when using a 12V adapter. | | | | |

⁽¹⁾ DESFire EV2 cards are supported by having backward compatibility of DESFire EV1 cards. CSN and smart card functions are compatible with FaceStation F2.

⁽²⁾ RF read range will vary depending on the installation environment.



Suprema Inc.

17F Parkview Tower, 248, Jeongjail-ro, Bundang-gu, Seongnam-si, Gyeonggi-do, 13554, Republic of Korea

T +82 31 783 4502 www.supremainc.com



For more information visit our website below by scanning the QR code.
<https://www.supremainc.com/en/about/contact-us.asp>